

I'm sorry I'm not much good at writing instructions. :(

Basic assembly Instructions for 0 / 00 Warehouse Scratch Aid Kit

These nice simple scratch Aid kit allows you to build up a nice two story Low Relief Warehouse / Factory Style building ..

Each kit has all the parts need to make a complete shell of a low relief building.

Including laser cut doors, windows, lintels & glazing

Made from Quality Card, MDF & Laserboard

As these are scratch aid kits, we leave it up to you how you finish them or Alter them for your own needs..

These Kits gives you a fantastic base for adding your own style & textures. As you can apply your own textures, these can be personalized to suit

your needs & you will have a very personal model that's is all your own!

I recommend a good wood glue for assembly, this is a scratch aid kit & it really is up-to you how you build it,

these simple assembly picture instructions are just an Example of how they can be made

This is all the wooden MDF Parts

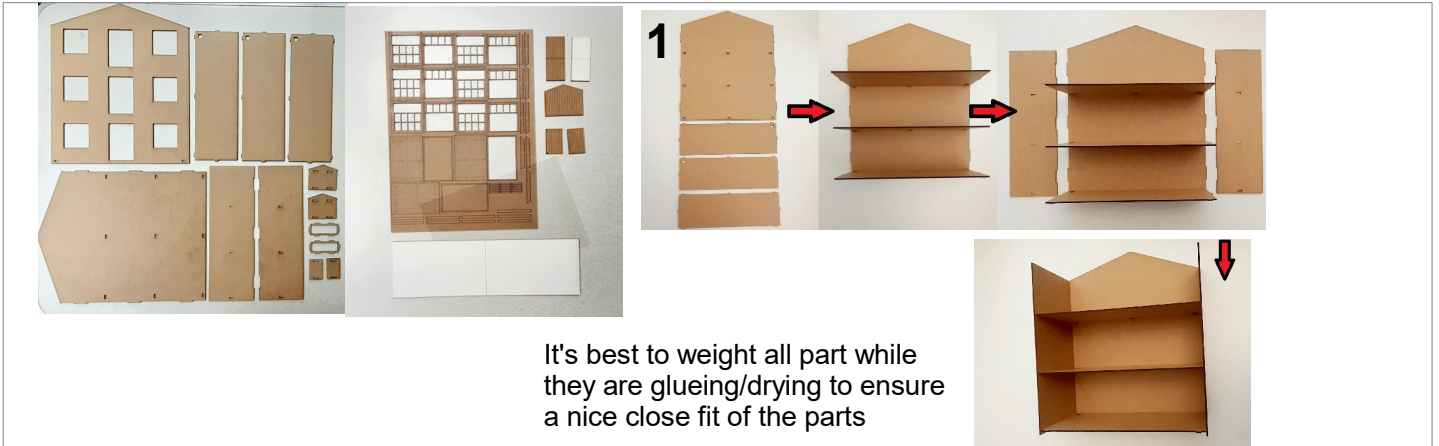

The windows are made from 3 parts, Outer frame, Inner frame & glazing.  
Glue the outer frame to the inner frame, using the guide lines on the inner frame.  
Before adding the glazing, it is recommend that you paint the frames the colour you want first.

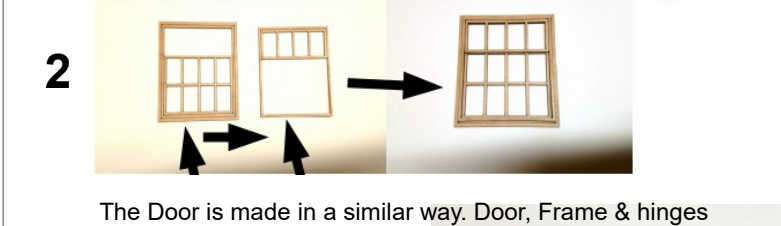

## Hoist

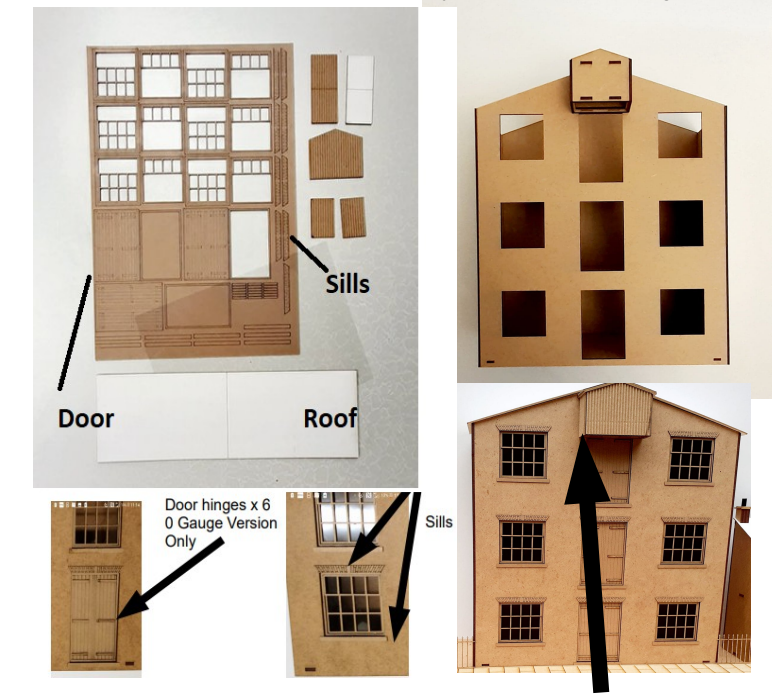
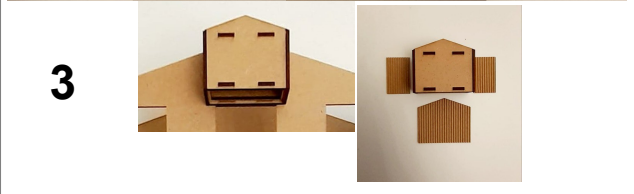
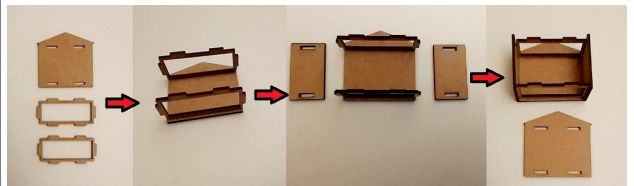

Its up to you how you make up this model. These are basic ideas. I recommend you fit what ever covering you are using first, be it brick paper or stone before fitting the windows. The idea is to make it your own.

**Don't forget the Roof!**



**Happy Modelling**